



Town of Whitby

Legal and By-law Services, By-law Services Division

Office Address: 3050 Garden Street, Unit 102, Whitby, ON L1R 2G7

Mailing Address: 575 Rossland Road East, Whitby, ON L1N 2M8

www.whitby.ca Phone: 905.430.4345

Pool Enclosure Permit Application

Part A: Permit, Approval and Deposit Information (this section for office use only)

Permit No.:	Date Received:
Application Received By:	Date Issued:
Permit Fee: (\$380)	Permit Issued By:

Required Deposits: (CASH, CHEQUE, DEBIT ONLY)

<input type="checkbox"/> Curb Deposit (\$1,118.70)	<input type="checkbox"/> Sidewalk Deposit (\$1,525.50)
<input type="checkbox"/> Town Fence Deposit (\$2,361.70)	<input type="checkbox"/> Boulevard Deposit (\$463.30)
Park Access Fee \$ _____	Other Fees: \$ _____

Required Approvals:

<input type="checkbox"/> CLOCA Approval Required	<input type="checkbox"/> CLOCA Permit Received
<input type="checkbox"/> Subdivision Assumed	<input type="checkbox"/> Developer Approval Received
<input type="checkbox"/> Regional Road	<input type="checkbox"/> Trans-Canada Pipeline
<input type="checkbox"/> Hydro Approval Required	<input type="checkbox"/> Health Department Approval Required

Part B: Property Address

Number and Street Name:	Whitby, Ontario
-------------------------	-----------------

Part C: Project Information

Description of Proposed Work:	<input type="checkbox"/> Above-ground Pool	<input type="checkbox"/> On-Ground Pool	<input type="checkbox"/> In-Ground Pool
Type of Pool Liner:	<input type="checkbox"/> Fiberglass	<input type="checkbox"/> Vinyl	<input type="checkbox"/> Other
Construction Start Date:			

Will you be constructing a deck or accessory building as part of this project?
(e.g. deck surrounding pool, pool house, equipment shed) Yes No

* If the answer to the above is yes, please note that a building permit may be required.
More information on building permit requirements is available through Building Services.



Town of Whitby

Legal and By-law Services, By-law Services Division

Office Address: 3050 Garden Street, Unit 102, Whitby, ON L1R 2G7

Mailing Address: 575 Rossland Road East, Whitby, ON L1N 2M8

www.whitby.ca Phone: 905.430.4345

Part D: Property Owner Information Applicant

First Name:

Last Name:

Corporation or Partnership Name (if applicable):

Street Number and Address:

City:

Province:

Postal Code:

Telephone:

Mobile:

Email Address:

Part E: Pool Company Information Applicant

First Name:

Last Name:

Corporation or Partnership Name (if applicable):

Street Number and Address:

City:

Province:

Postal Code:

Telephone:

Mobile:

Email Address:

Part F: Construction Information

Do you have a septic system?

Yes

No

* *If you have a septic system, approval from the Region of Durham is required prior to beginning construction of the swimming pool.*

Is there an easement on the property?

Yes

No

* *It is the responsibility of the owner/applicant to research whether or not an easement is located on the property. No part of the swimming pool may be located within the easement.*



Town of Whitby

Legal and By-law Services, By-law Services Division

Office Address: 3050 Garden Street, Unit 102, Whitby, ON L1R 2G7

Mailing Address: 575 Rossland Road East, Whitby, ON L1N 2M8

www.whitby.ca Phone: 905.430.4345

Part F: Construction Information (continued)

Will a bobcat, backhoe, truck or other heavy equipment be used to excavate and/or construct the swimming pool? Yes No

Will construction access take place by using the driveway? Yes No

Will construction access take place by crossing the boulevard? Yes No

Will construction access take place by using a side street that is different than the street that the property is located on? Yes No

* *If the answer to the question above is 'yes', please indicate the name of the side street on the line to the right.*

Will construction access take place by crossing through parkland or open space? Yes No

* *If the answer to the question above is 'yes', please indicate the name of the park or open space on the line to the right.*

Part G: Fencing and Gate Information

Is the fence an existing fence? Yes No

Please indicate the style of fence. Board Fencing Chain Link Wrought Iron Other

Have you provided a detailed drawing of your fence design? Yes No

* *Please note that a detailed drawing showing the dimensions from the top of the bottom rail to the top of the top rail and the distance between vertical members is required.*

Part H: Declaration of Applicant

I, the undersigned, hereby declare that this information included in this application package is true and correct to the best of my knowledge. I further declare that I have the required legal authority to act on behalf of the corporation or partnership with respect to this application, if applicable.

Signature:

Date:

Personal information collected on this form is collected under the authority of the Municipal Freedom on Information and Protection of Privacy Act. The information will only be used for the purpose of administering the requirements of the pool enclosure permit. Questions regarding the collection of personal information can be directed to the Town Clerk, 575 Rossland Rd. E., Whitby, ON.



Town of Whitby

Legal and By-law Services, By-law Services Division

Office Address: 3050 Garden Street, Unit 102, Whitby, ON L1R 2G7

Mailing Address: 575 Rossland Road East, Whitby, ON L1N 2M8

www.whitby.ca Phone: 905.430.4345

Part I: Pool Location

Using the area below as a guideline, please indicate the location of the driveway on the property, the house and the proposed swimming pool. Please indicate the distances from the water's edge of the pool to the property lines (in all direction). The minimum setback between the water's edge and the property line is 1 metre. Also, please be sure to indicate the location of any gate(s) and the type of fence (e.g. chain link, board fencing, and wrought iron) on each side of the pool enclosure.



**Approved for
Setbacks Only**

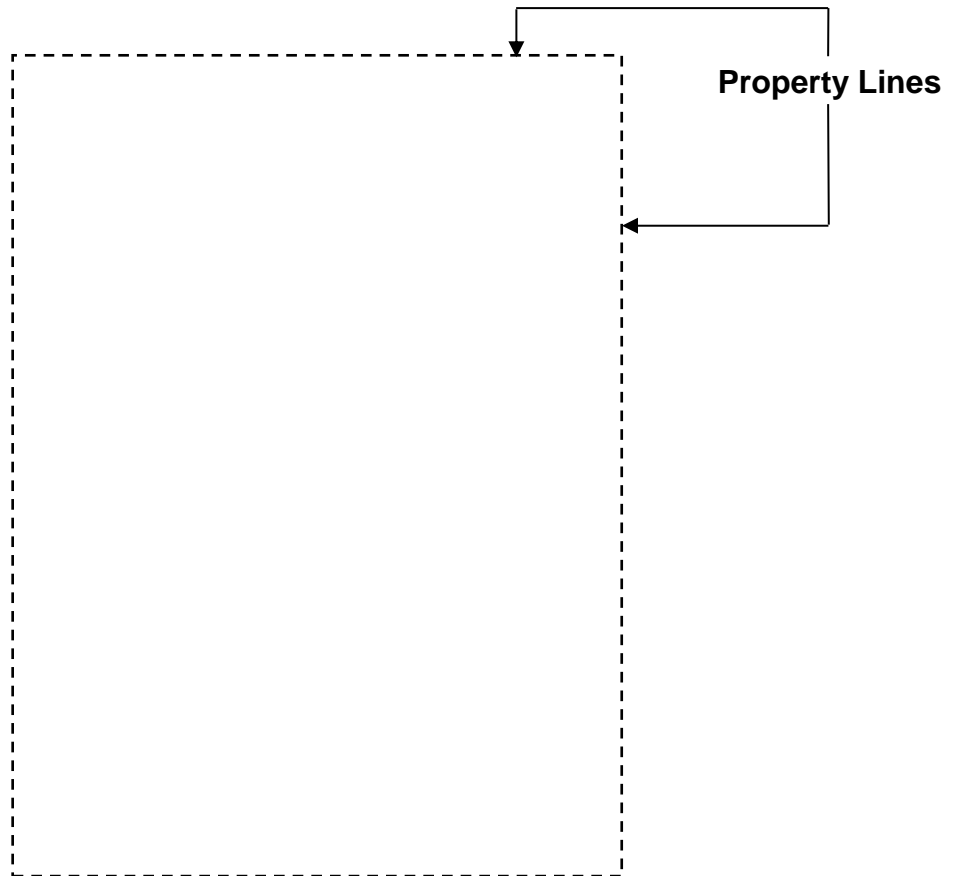

*

In case of permit application cancellation by the applicant, only 40% of the permit fee will be refunded.